

EMERGENCY PREPAREDNESS AND RESPONSE PROTOCOL: EARTHQUAKES

Because the potential for seismic activity exists in the area, the Office of International Programs (OPI) at Universidad San Francisco de Quito (USFQ) would like to inform all of our international students and their sending universities/organizations of the following information.

Although we cannot predict when an earthquake will occur or the level of intensity if one occurs, the USFQ community has prepared an extensive emergency response protocol in the event of an earthquake. International students should read the following information thoroughly in order to know what steps to take during and after an earthquake.

Before an earthquake occurs:

- Familiarize yourself with the appropriate steps to take during and after an earthquake, including the list of items you are advised to carry with you at all times, campus safe zones, and emergency response protocols.
- Familiarize yourself with the potential risks associated with your accommodations and (if applicable) discuss any earthquake protocols and/or safe zones with your host family.
- Determine objects that may pose a danger to you in the event of an earthquake, such as windows, tables, lamps, hanging objects, etc., and, if possible, relocate or secure them.
- Keep the following items with you **at all times**: copies of your identification documents (e.g. passport); bottled water; and a list of emergency telephone numbers.

During an earthquake:

- Remain calm and follow the instructions of your professor(s), campus security guards, police officers, or other persons of authority.
- Depending on your location at the time of the earthquake, take the following precautions:
 - **Outside:** Get into an open area. Stay away from buildings, trees, streetlights, electric cables, and other structures that could be damaged and fall during the earthquake.
 - **Inside:** Do not run for the doors. Instead, seek shelter under a desk or table away from windows, light fixtures, bookshelves, exterior doors and walls, and other objects that present a risk of breaking or falling on you. Make sure to hold on to the desk or table as it may shift during the earthquake. If you do not have access to a desk or table, cover your face and head with your hands and stay away from hazards such as windows or shelves.
 - **In a moving vehicle:** Stop the vehicle as soon as possible, avoiding stopping near or beneath buildings, trees, telephone poles, or electric wires. Remain inside the vehicle until the earthquake passes and then proceed cautiously, checking the road conditions for damages. If you need to leave the vehicle, exercise caution near trees, electric wires, and other objects that may have been damaged during the earthquake and could pose a risk of falling on you.

Following an earthquake:

- Continue to remain calm and follow the instructions of your professor(s), campus security guards, police officers, or other persons of authority regarding where/how to proceed with evacuation as necessary.
- If you are trapped beneath debris, do not try to light a fire. Try not to move, as this will stir up dust. Cover your mouth and nose with a handkerchief or your clothing. Tap on a pipe or wall so that rescue personnel can find you. Use a whistle if you have one. Shout only as a last resort as the dust may affect you if you shout.
- Otherwise, go to a safe zone. If you are inside a building, leave the building and proceed to a secure area. If you are on the main USFQ campus in Cumbayá, go to one of the designated safe zones. Do not use any elevators.
- Check for injuries. Do not try to move people who are seriously injured unless they are in immediate danger of death or further injury. If you must move an unconscious person, first make sure to stabilize the person's neck and back. Then call for help immediately. Keep the injured person warm with blankets or clothing, but take care to ensure that they do not overheat. Do not give any water or liquids to an unconscious person.
- Once you have reached a safe location, check in with family, friends, and the USFQ Office of International Programs, if possible, to advise them of your location and your health status. Keep in mind that cellular networks and internet access may be disrupted following the earthquake.
- Students who are not on campus during the earthquake should remain in a secure off-campus location and wait for an assessment from the USFQ Risk Management Committee regarding building safety. An announcement will be made regarding when regular activities, including classes, will resume.

Additional important information:

- If the earthquake results in a loss of electricity, use only battery-powered flashlights or lanterns. Do not use candles or matches since there may be a gas leak.
- International students are also encouraged to visit OPI's office for further advice or assistance.
- Please familiarize yourself with the following information:

EARTHQUAKE EMERGENCY RESPONSE NUMBERS:

CONTACT	TELEPHONE NUMBER
National-level Emergency Response Center Police Department Fire Department Ambulance & Medical Emergencies	911
USFQ Earthquake Emergency Response Coordinator	0999723992
USFQ Earthquake on-call Medical Staff	0998367810
USFQ Earthquake Health & Safety Coordinator	0983890342
USFQ-OPI Emergency Contact for International Students ONLY	0980834444

EVACUATION MAP: USFQ CUMBAYA CAMPUS

- RISK AREAS & SAFE ZONES

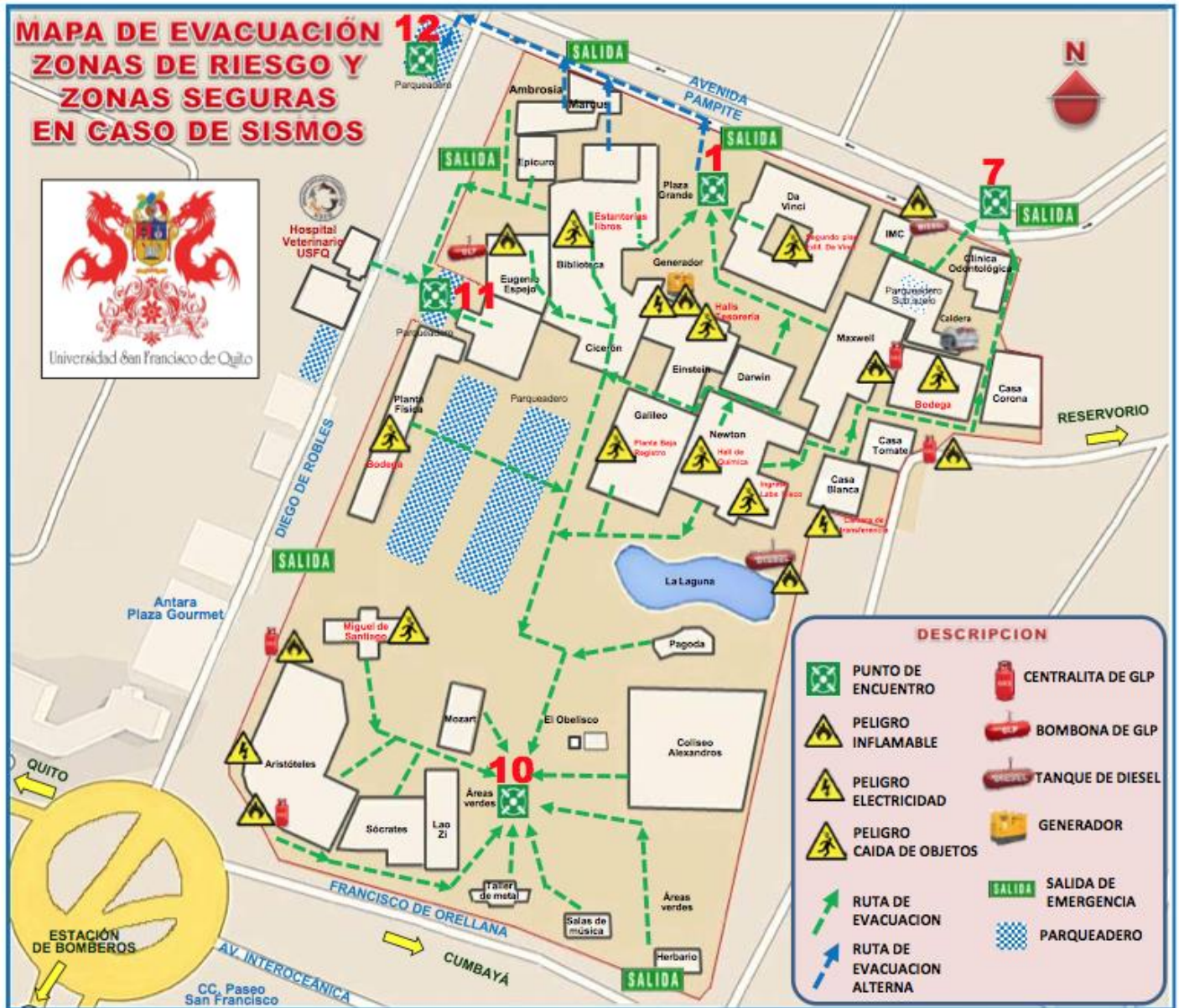

EVACUATION MAP: PASEO SAN FRANCISCO

– RISK AREAS & SAFE ZONES



EVACUATION MAP: MEDICAL SCHOOL

– RISK AREAS & SAFE ZONES

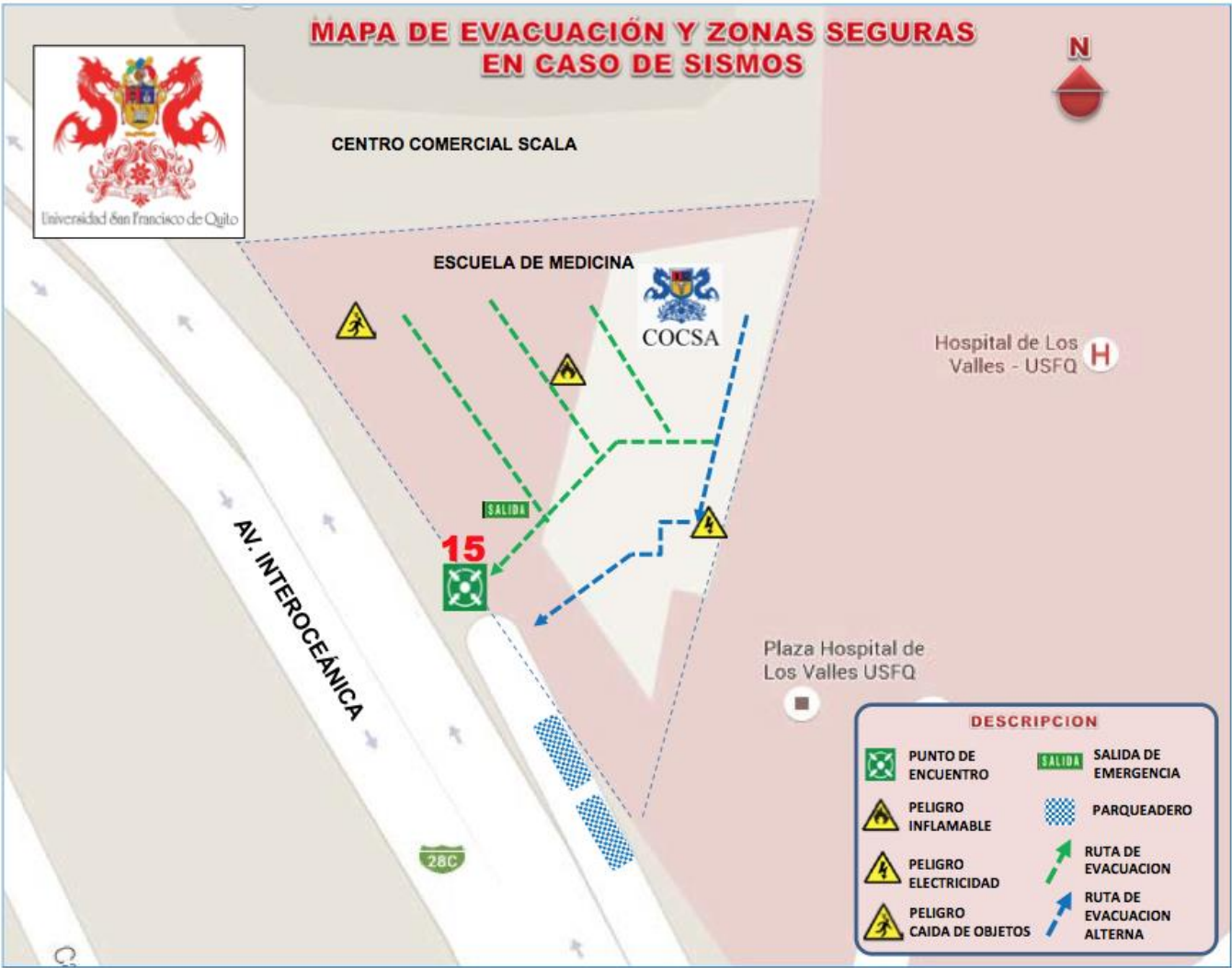

EVACUATION MAP: QUITO METROPOLITAN AREA

– RISK AREAS & SAFE ZONES

CONOCE Y RECONOCE TU SITIO SEGURO, HAY UNO CERCA DE TI



If any international student or international university/organization has a question or concern about earthquake safety, please visit us at Casa Tomate or send us an email at opi@usfq.edu.ec.